

IDEAL VT80WK

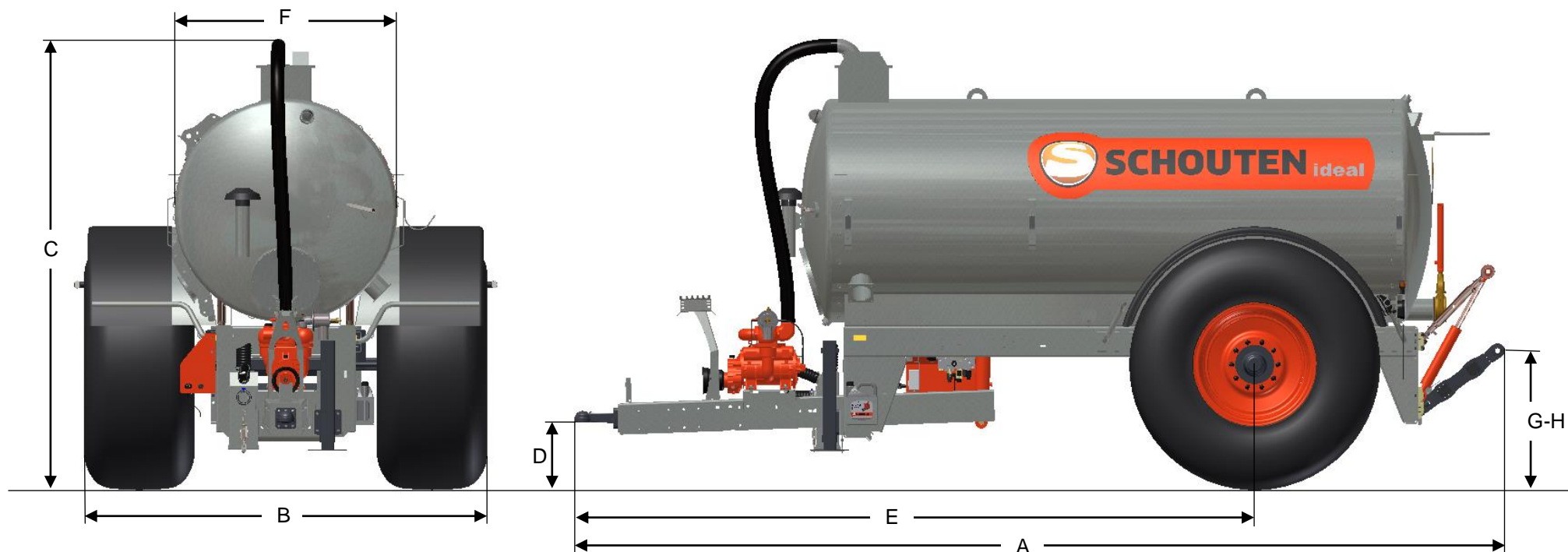

DIMENSIONS

| | | | | | |
|---|--------------|------------|---|-----------------------|---------|
| A | LENGTH | 6612 MM | E | DISTANCE HITCH - AXLE | 4816 MM |
| B | WIDTH | 2795 MM | F | TANK DIAMETER | 1600 MM |
| C | HEIGHT | 3225 MM | G | LIFT HEIGHT MIN. | 235 MM |
| D | HITCH HEIGHT | 400-700 MM | H | LIFT HEIGHT MAX. | 990 MM |

IDEAL VT80WK

MACHINE INFORMATION

| | |
|------------------------|------------------|
| TYPE | VT80WK |
| WEIGHT | 2.830 KG |
| TANK DIMENSIONS | Ø1600X4040 MM |
| TANK VOLUME | 8.600 L |
| LEVEL INDICATOR | FLOAT POINTER |
| UNDERCARRIAGE | SINGLE-AXLE |
| TYPE OF AXLE | BPW BRAKED □90MM |
| CARRYING CAPACITY AXLE | 10.000 KG |
| TIRES | 800/60R32 |

| | |
|------------------------|----------------------|
| SUPPORT LEG | HYDR. DA |
| VACUUM PUMP | B&P MEC11000 |
| CAPACITY VACUUM PUMP | 11.137 L/MIN |
| VACUUM PUMP DRIVE | PTO 540/1000RPM |
| MOISTURE TRAP CAPACITY | 15.500 L/MIN |
| LIFT POSSIBILITIES | GRASSLAND/BLACK SOIL |
| LIFT CAPACITY | 3.500 KG |
| LIFT SYSTEM | 4-POINT CAT III |

OPTIONS

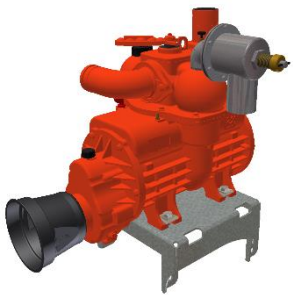

B&P MEC13500

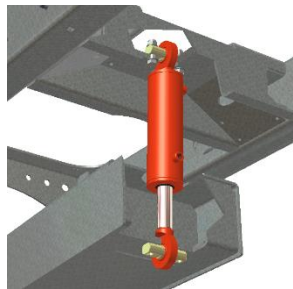

HYDR. DRAWBAR SUSPENSION

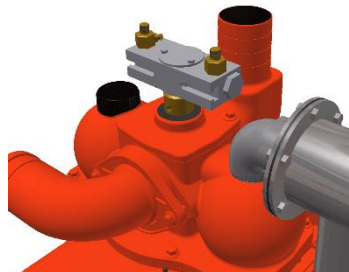

HYDR. PUMP SWITCHING

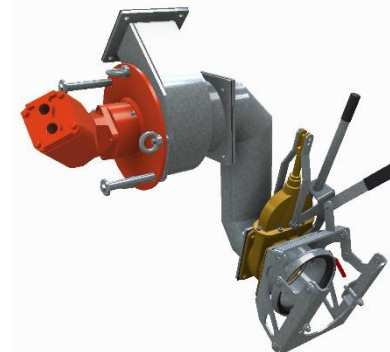

TURBO-FILLER 8-6



DOCKING FILLING ARM 8"